

Swing handle lock

A-1120



RL

IP65

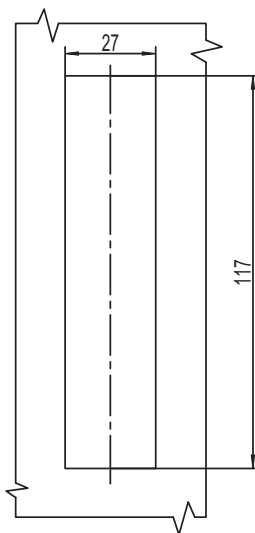
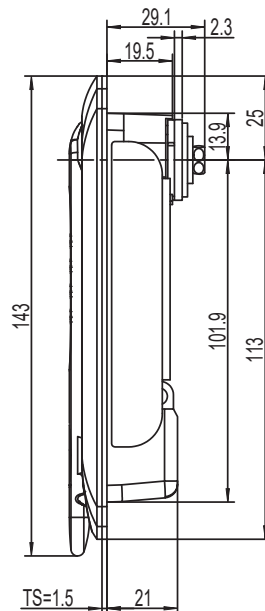
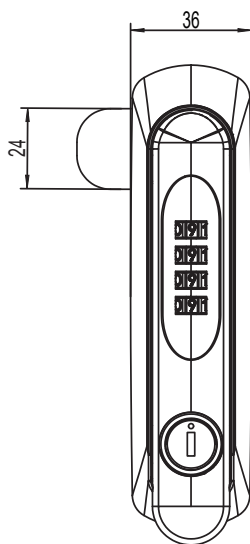

开孔尺寸
Panel Cutout

如 需 获 得 产 品 3 D 模 型 图 请 联 系 W W W . F O R N D . C O M

1. Material and surface treatment:
Lock body, handle: Zamak DIN-EN 1774-ZnAl4Cu1
Steel bolt: iron galvanized
Sealing ring: EPDM foam.

2. Performance parameters:
Protection class: IP65
Handle bearing tension value: $\leq 390\text{N}$
Handle bearing torque value: $\leq 12\text{N}\cdot\text{m}$
Maximum static load: 300N

3. Function Description:
Set the activation password, which can be used to unlock the lock. The administrator can use the management key to unlock or retrieve the password.
Handle opens upwards, 90 degree rotation opens.

4. Remarks:
Default key K333

1.材质及表面处理:
锁体, 手柄: 5#锌合金
钢栓: 铁镀锌
密封圈: EPDM发泡胶。

2.性能参数:
防护等级: IP65
手柄承载力值: $\leq 390\text{N}$
手柄承载扭矩值: $\leq 12\text{N}\cdot\text{m}$
最大静载荷: 300N

3.结构说明:
设置开启密码, 输入密码既可以开锁。管理员使用管理钥匙开启, 或者重新找回密码。
手柄向上打开, 90度旋转开启

4.备注:
默认钥匙 K333

锌合金 Zin alloy		
喷塑黑 Powder coating black	亮铬 Bright chrome plating	纳米喷漆 (银亚光) NM spray painting (matte silver)
A-1120-40	A-1120-30	A-1120-50